

# For Lease

## 441 Smithfield Street

Pittsburgh, Pennsylvania 15222



### Premises

- 3,915 SF (Street Level)
- 12, 534 SF (Lower Level)

### Features

- Prominent location provides high traffic in the heart of Pittsburgh's Central Business District
- Close proximity to Macy's and Saks Fifth Avenue

For more information,  
please contact:

**Arthur J. DiDonato, Jr.**  
Sr. Vice President/Retail Brokerage

412.261.0200 ext. 436  
adidonato@oxfordrealtyservices.com



**OXFORD**  
**REALTY SERVICES**

Office | Industrial | Retail | Investment | Consulting

Oxford Realty Services

One Oxford Centre | 301 Grant Street | Suite 400

Pittsburgh, PA, 15219

[www.oxfordrealtyservices.com](http://www.oxfordrealtyservices.com)

# 441 Smithfield Street, Pittsburgh, Pennsylvania

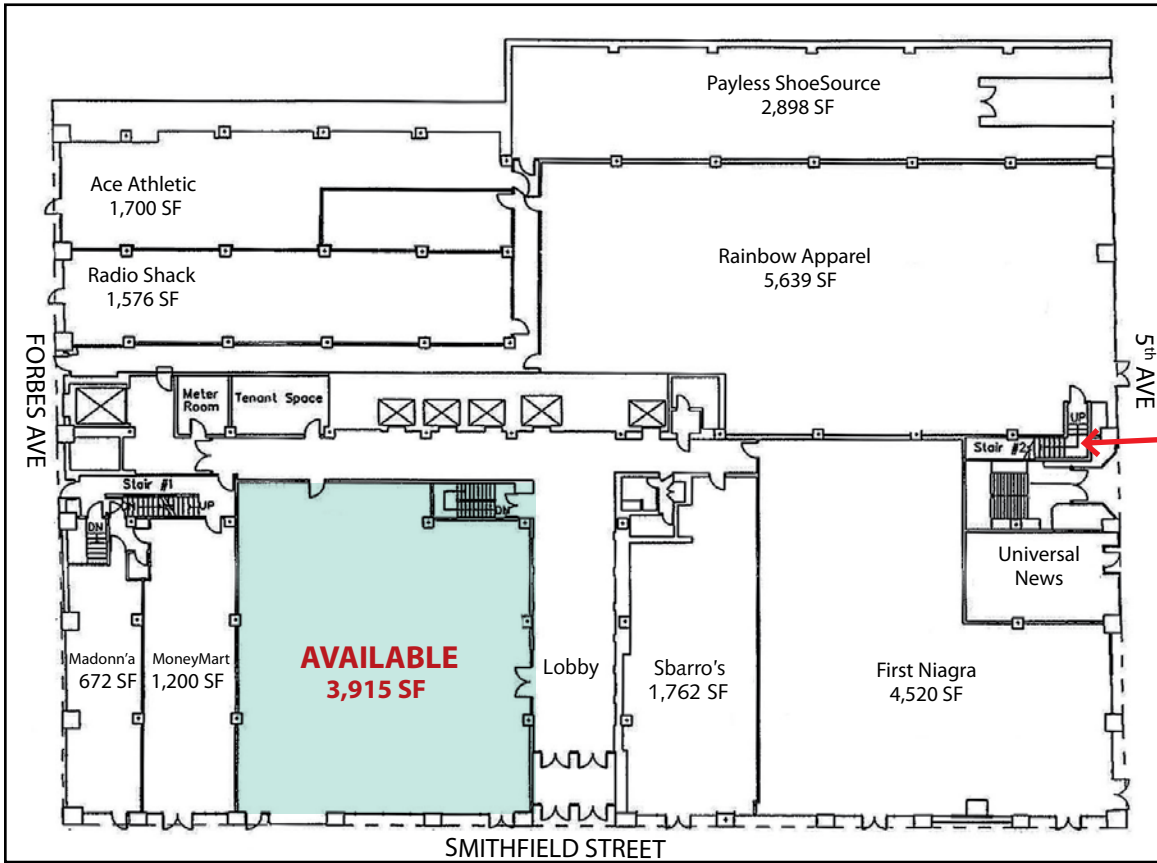

Entrance to lower level space faces 5<sup>th</sup> Avenue  
12,534 SF Available



Although all information furnished regarding property for sale, rental or financing is from sources deemed reliable, such information has not been verified, and no express representation is made nor is any to be implied as to the accuracy thereof, and it is submitted subject to errors, omissions, change of price, rental or other conditions, prior sale, lease or financing, or withdrawal without notice. Rental terms and all dimensions are approximate and specifications are subject to change without notice. Oxford Realty Services, Inc., an independent real estate services company.



**OXFORD**  
**REALTY SERVICES**

Office | Industrial | Retail | Investment | Consulting